

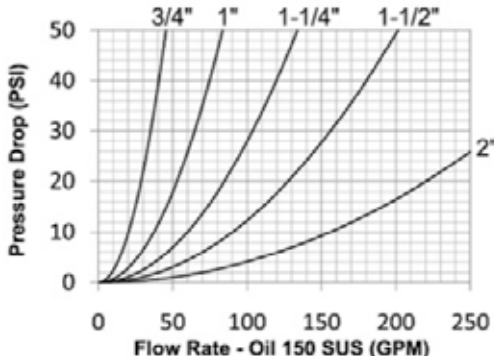

WS-Series Hydraulic Couplings

Interchange Data:

- High Pressure Wingstyle Interchange
- Snap-Tite 75-Series, Hydraulics Inc. Series-5TV



Materials:

- Machined components are manufactured using solid steel or 316 stainless steel bar stock.
- Stainless steel retaining rings, and springs maximize corrosion resistance and extend service life.
- Steel componentry is plated using ROHS Compliant Trivalent Chrome.
- Rugged high-strength steel shell-cast wing nut for threaded connect and disconnect operation.
- 316 stainless steel nipple connection-threads are coated to prevent galling during connection/disconnection.
- 1 1/4" and 1 1/2" 316 stainless steel couplers have a hex-nut connection sleeve.

Seal Components:

- Nitrile (Buna-N) seals are standard, providing a temperature range of -40°F to +250°F (-40°C to +121°C).
- Teflon® anti-extrusion ring protects main coupling O-Ring from dynamic impulse pressure damage.
- Main valve seal is 'housed' to improve seal integrity during pressurized connection/disconnection.
- Blow-out Prevention (BOP) couplings contain fire service grade Viton® seals - coupling has been fire tested and Lloyd's certified to 700°C (1300°F) in accordance with API 16D (Certificate #NAO 0601041/1).

Rated Pressure Chart:

Body Size	WS-Series High Pressure Wingstyle Interchange (Connected)							
	Steel Coupler/Plug				316 SS Coupler/Plug			
	Maximum Working		Burst		Maximum Working		Burst	
	PSI	Bar	PSI	Bar	PSI	Bar	PSI	Bar
3/4"	5,000	345	32,800	2,200	3,000	200	20,000	1,400
1"	5,000	345	25,100	1,700	3,000	200	20,000	1,400
1 1/4"	5,000	345	15,000	1,000	3,000	200	15,000	1,000
1 1/2"	5,000	345	19,300	1,300	3,000	200	15,000	1,000
2"	5,000	345	15,000	1,000	3,000	200	15,000	1,000



Body Size	WS-Series High Pressure Wingstyle Interchange Coupler (Female Threads)										
	Part Detail			Length		Maximum OD		Hex Inch	Weight Lb	Package Qty	
	Part #	Threads	Material	Inch	mm	Inch	mm			Bag	Box
3/4"	6WSF4	1/2"-14 NPTF	steel	2.76	70.1	3.23	82.0	-	1.86	-	5
3/4"	6WSF6	3/4"-14 NPTF	steel	2.76	70.1	3.23	82.0	-	1.80	-	5
3/4"	6WSF6-SS	3/4"-14 NPTF	316 stainless	2.76	70.1	3.23	82.0	-	1.80	-	5
1"	8WSF8	1"-11 1/2 NPTF	steel	3.45	87.6	4.00	101.6	-	3.30	-	5
1"	8WSF8-SS	1"-11 1/2 NPTF	316 stainless	3.45	87.6	4.00	101.6	-	3.30	-	5
1 1/4"	10WSF10	1-1/4"-11 1/2 NPTF	steel	4.40	111.8	4.65	118.1	-	5.70	-	1
1 1/4"	10WSF10-SS	1-1/4"-11 1/2 NPTF	316 stainless	4.40	111.8	4.65	118.1	-	5.70	-	1
1 1/2"	12WSF12	1-1/2"-11 1/2 NPTF	steel	5.13	130.3	5.43	137.9	-	8.90	-	1
1 1/2"	12WSF12-SS	1-1/2"-11 1/2 NPTF	316 stainless	5.13	130.3	5.43	137.9	-	8.90	-	1
2"	16WSF16	2"-11 1/2 NPTF	steel	6.09	154.7	6.73	170.9	-	17.10	-	1
2"	16WSF16-SS	2"-11 1/2 NPTF	316 stainless	6.09	154.7	6.73	170.9	-	17.10	-	1

Note: BSP & ORB threads are available on request.



WS-Series Hydraulic Couplings

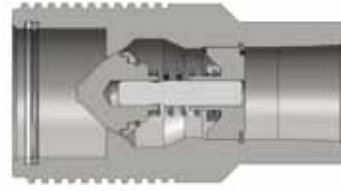

Body Size	WS-Series High Pressure Wingstyle Interchange Nipple (Female Threads)										
	Part Detail			Length		Maximum OD		Hex Inch	Weight Lb	Package Qty	
	Part #	Threads	Material	Inch	mm	Inch	mm			Bag	Box
3/4"	WS6F4	1/2"-14 NPTF	steel	3.27	83.1	1.74	44.2	-	1.23	-	5
3/4"	WS6F6	3/4"-14 NPTF	steel	3.27	83.1	1.74	44.2	-	1.20	-	5
3/4"	WS6F6-SS	3/4"-14 NPTF	316 stainless	3.27	83.1	1.74	44.2	-	1.20	-	5
1"	WS8F8	1"-11 1/2 NPTF	steel	4.18	106.2	2.25	57.2	-	2.50	-	5
1"	WS8F8-SS	1"-11 1/2 NPTF	316 stainless	4.18	106.2	2.25	57.2	-	2.50	-	5
1 1/4"	WS10F10	1-1/4"-11 1/2 NPTF	steel	5.38	136.7	2.63	66.8	-	4.10	-	1
1 1/4"	WS10F10-SS	1-1/4"-11 1/2 NPTF	316 stainless	5.38	136.7	2.63	66.8	-	4.10	-	1
1 1/2"	WS12F12	1-1/2"-11 1/2 NPTF	steel	5.98	151.9	3.25	82.6	-	6.90	-	1
1 1/2"	WS12F12-SS	1-1/2"-11 1/2 NPTF	316 stainless	5.98	151.9	3.25	82.6	-	6.90	-	1
2"	WS16F16	2"-11 1/2 NPTF	steel	7.05	179.1	4.00	101.6	-	12.50	-	1
2"	WS16F16-SS	2"-11 1/2 NPTF	316 stainless	7.05	179.1	4.00	101.6	-	12.50	-	1



Body Size	WS-Series Coupler Rigid Dust Plug					
	Part Detail			Weight Lb	Package Qty	
	Part #	Lanyard	Body		Bag	Box
3/4"	6WSDP-A	SS Bead Chain	aluminum	0.31	5	25
1"	8WSDP-A	SS Bead Chain	aluminum	0.48	-	10
1 1/4"	10WSDP-A	SS Bead Chain	aluminum	0.61	-	10
1 1/2"	12WSDP-A	SS Bead Chain	aluminum	0.86	-	5
2"	16WSDP-A	SS Bead Chain	aluminum	1.05	-	5



Body Size	WS-Series Nipple Rigid Dust Cap					
	Part Detail			Weight Lb	Package Qty	
	Part #	Lanyard	Body		Bag	Box
3/4"	WS6DC-A	SS Bead Chain	aluminum	0.31	5	25
1"	WS8DC-A	SS Bead Chain	aluminum	0.48	-	10
1 1/4"	WS10DC-A	SS Bead Chain	aluminum	0.61	-	10
1 1/2"	WS12DC-A	SS Bead Chain	aluminum	0.86	-	5
2"	WS16DC-A	SS Bead Chain	aluminum	1.05	-	5

Note: BSP & ORB threads are available on request.



W-Series Hydraulic Couplings

Interchange Data:

- Aeroquip 5100-Series, Parker 6100-Series
- Snap-Tite 78-Series, Faster Series-FB, Safeway S51-Series

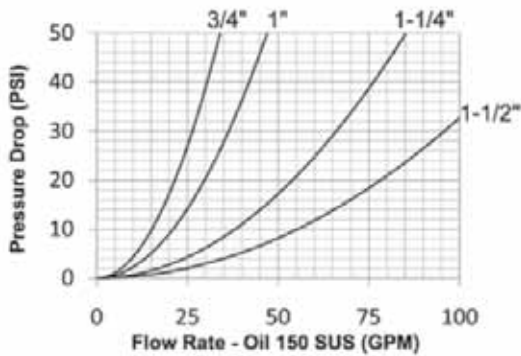

Materials:

- Machined components are manufactured using solid steel and brass bar stock.
- Stainless steel retaining rings, and springs maximize corrosion resistance and extend service life.
- Steel componentry is plated using ROHS Compliant Trivalent Chrome.
- Rugged steel cast wing nut for threaded connect and disconnect operation.
- For steel models, coupler valve sleeve and nipple valve are constructed of brass.

Seal Components:

- Nitrile (Buna-N) seals are standard, providing a temperature range of -40°F to +250°F (-40°C to +121°C).
- 3/4" and 1" couplings have a Teflon® back-up ring on the valve sleeve to extend service life.
- Main coupler valve has a bonded face-seal to improve seal integrity during pressurized connection/disconnection.
- 3/4" and 1 1/2" nipple valve seal is bonded to the valve face to improve seal integrity and prolong service life.
- External O-Ring on plug indicates full connection and acts as a contamination shield in connected mode.
- Redundant O-Ring on the coupler body will engage nipple for secondary sealing support.

Rated Pressure Chart:

Body Size	W-Series Wingstyle Interchange (Connected)			
	Coupler/Plug			
	Maximum Working		Burst	
	PSI	Bar	PSI	Bar
3/4"	3,000	200	12,300	850
1"	3,000	200	14,100	1,000
1 1/4"	2,750	190	8,800	600
1 1/2"	2,500	170	8,800	600

Although the wingstyle couplings are able to connect and disconnect while under pressure, it is recommended that hydraulic power supply be de-energized during connection to ensure operator safety. If it is not possible to de-energize the circuit, operators must be aware of their surroundings to ensure that an attachment or tool does not put them at risk, once hydraulic power is applied during the connection process.

W-Series couplings are not recommended for continuous hydraulic impulse applications at rated pressures.



Body Size	W-Series Wingstyle Interchange Coupler (Female Threads)										
	Part Detail			Length		Maximum OD		Flats Inch	Weight Lb	Package Qty	
	Part #	Threads	Material	Inch	mm	Inch	mm			Bag	Box
3/4"	6WF4-B	1/2"-14 NPTF	brass	3.09	78.5	4.06	103.1	1.15	1.30	-	10
3/4"	6WF6-B	3/4"-14 NPTF	brass	3.09	78.5	4.06	103.1	1.15	1.30	-	10
1"	8WF8-B	1"-11 1/2 NPTF	brass	3.78	96.0	4.45	113.0	1.44	1.89	-	10
1"	8WF8	1"-11 1/2 NPTF	steel	3.78	96.0	4.45	113.0	1.44	1.89	-	10
1 1/4"	10WF10-B	1-1/4"-11 1/2 NPTF	brass	3.97	100.8	5.20	132.1	1.78	2.76	-	5
1 1/2"	12WF12-B	1-1/2"-11 1/2 NPTF	brass	4.08	103.6	5.35	135.9	2	3.52	-	5

Note: BSP threads are available on request.



W-Series Hydraulic Couplings

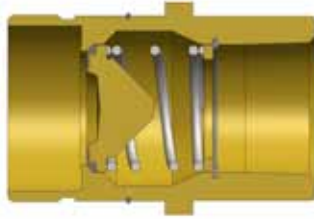

Body Size	W-Series Wingstyle Interchange Nipple (Female Threads)										
	Part Detail			Length		Maximum OD		Hex Inch	Weight Lb	Package Qty	
	Part #	Threads	Material	Inch	mm	Inch	mm			Bag	Box
3/4"	W6F4-B	1/2"-14 NPTF	brass	3.10	78.7	1.78	45.2	1-5/16	0.82	-	10
3/4"	W6F6-B	3/4"-14 NPTF	brass	3.10	78.7	1.78	45.2	1-5/16	0.76	-	10
1"	W8F8-B	1"-11 1/2 NPTF	brass	3.55	90.2	2.00	50.8	1-9/16	1.30	-	10
1"	W8F8	1"-11 1/2 NPTF	steel	3.55	90.2	2.00	50.8	1-9/16	1.30	-	10
1 1/4"	W10F10-B	1-1/4"-11 1/2 NPTF	brass	3.71	94.2	2.38	60.5	1-7/8	1.65	-	5
1 1/2"	W12F12-B	1-1/2"-11 1/2 NPTF	brass	4.11	104.4	2.83	71.9	2-1/2	2.61	-	5



Body Size	W-Series Wingstyle Interchange Coupler Rigid Dust Plug					
	Part Detail			Weight Lb	Package Qty	
	Part #	Lanyard	Body		Bag	Box
3/4"	6WDP-B	SS Bead Chain	brass	0.31	10	50
1"	8WDP-B	SS Bead Chain	brass	0.48	10	50
1 1/4"	10WDP-B	SS Bead Chain	brass	0.61	5	25
1 1/2"	12WDP-B	SS Bead Chain	brass	1.20	5	25



Body Size	W-Series Wingstyle Interchange Nipple Rigid Dust Cap					
	Part Detail			Weight Lb	Package Qty	
	Part #	Lanyard	Body		Bag	Box
3/4"	W6DC-B	SS Bead Chain	brass	0.36	10	50
1"	W8DC-B	SS Bead Chain	brass	0.37	10	50
1 1/4"	W10DC-B	SS Bead Chain	brass	0.62	5	25
1 1/2"	W12DC-B	SS Bead Chain	brass	1.03	5	25

Body Size	W-Series Wingstyle Interchange Coupler Repair Kits					
	Part Detail			Repair Kit Contents (for one coupler)	Package Qty	
	Part #	Coupler Style	Seal Material		Bag	Box
3/4"	6W-RKIT	all	Nitrile	Bonded Valve, O-Rings, & Teflon® Backup	1	25
1"	8W-RKIT	all	Nitrile	Bonded Valve, O-Rings, & Teflon® Backup	1	25
1 1/4"	10W-RKIT	all	Nitrile	Bonded Valve, O-Rings, & Teflon® Backup	1	25
1 1/2"	12W-RKIT	all	Nitrile	Bonded Valve, O-Rings, & Teflon® Backup	1	25

Body Size	W-Series Wingstyle Interchange Nipple Repair Kits					
	Part Detail			Repair Kit Contents (for one coupler)	Package Qty	
	Part #	Coupler Style	Seal Material		Bag	Box
3/4"	W6-RKIT	all	Nitrile	Valve Assembly & O-Ring	1	25
1"	W8-RKIT	all	Nitrile	Valve Assembly & O-Ring	1	25
1 1/4"	W10-RKIT	all	Nitrile	Valve Assembly & O-Ring	1	25
1 1/2"	W12-RKIT	all	Nitrile	Valve Assembly & O-Ring	1	25

Note: BSP threads are available on request.



ST-Series Hydraulic Couplings

Interchange Data:

- Interchangeable with Snap-Tite 71-Series

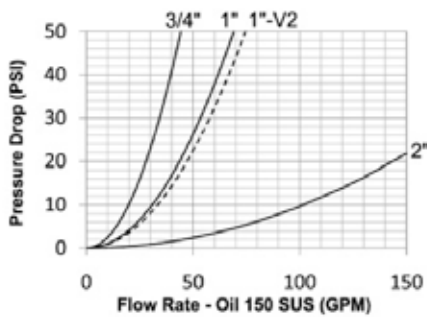
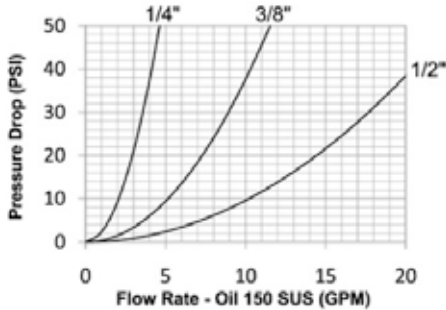

Materials:

- Machined components are manufactured using solid steel or 316 stainless bar stock.
- Stainless steel balls, retaining rings, and springs maximize corrosion resistance and extend service life.
- Steel componentry is plated using ROHS Compliant Trivalent Chrome.
- Steel coupler sleeves are hardened to resist deformation and maximize service life.
- Steel nipples are hardened to provide heavy duty performance.

Seal Components:

- Nitrile (Buna-N) seals are standard, providing a temperature range of -40°F to +250°F (-40°C to +121°C).
- All couplers and nipples incorporate Teflon® anti-extrusion rings to protect the seal components from dynamic impulse damage.

Rated Pressure Chart:

Body Size	ST-Series Snap-Tite 71-Series Interchange							
	Steel Coupler/Plug Coupled				316 SS Coupler/Plug Coupled			
	Maximum Working		Burst		Maximum Working		Burst	
	PSI	Bar	PSI	Bar	PSI	Bar	PSI	Bar
1/4"	10,000	700	27,300	1,800	5,000	345	28,000	1,900
3/8"	10,000	700	27,300	1,800	5,000	345	28,000	1,900
1/2"	10,000	700	22,500	1,500	5,000	345	25,000	1,700
3/4"	7,500	500	20,200	1,400	5,000	345	22,800	1,550
1"	7,500	500	19,400	1,300	4,000	275	18,500	1,250
1"-V2	8,500	585	25,900	1,750	-	-	-	-
2"	5,000	345	16,000	1,100	3,000	200	10,000	700

Note: BSP & ORB threads are available on request.



ST-Series Hydraulic Couplings

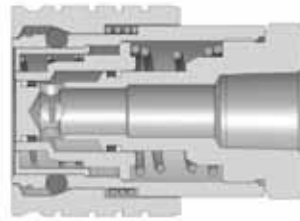

Body Size	ST-Series Snap-Tite 71-Series Interchange Coupler (Female Threads)										
	Part Detail			Length		Maximum OD		Hex Inch	Weight Lb	Package Qty	
	Part #	Threads	Material	Inch	mm	Inch	mm			Bag	Box
1/4"	2STF2	1/4"-18 NPTF	steel	1.96	49.8	1.23	31.2	15/16	0.25	5	25
1/4"	2STF2-SS	1/4"-18 NPTF	316 stainless	1.96	49.8	1.23	31.2	15/16	0.26	5	25
3/8"	3STF2	1/4"-18 NPTF	steel	2.36	59.9	1.6	40.6	1-3/16	0.38	5	25
3/8"	3STF3	3/8"-18 NPTF	steel	2.36	59.9	1.6	40.6	1-3/16	0.37	5	25
3/8"	3STF3-SS	3/8"-18 NPTF	316 stainless	2.36	59.9	1.6	40.6	1-3/16	0.38	5	25
3/8"	3STF4	1/2"-14 NPTF	steel	2.36	59.9	1.6	40.6	1-3/16	0.36	5	25
3/8"	3STF4-SS	1/2"-14 NPTF	316 stainless	2.36	59.9	1.6	40.6	1-3/16	0.37	5	25
1/2"	4STF4	1/2"-14 NPTF	steel	2.77	70.4	1.98	50.3	1-1/2	0.47	-	20
1/2"	4STF4-SS	1/2"-14 NPTF	316 stainless	2.77	70.4	1.98	50.3	1-1/2	0.49	-	20
3/4"	6STF6	3/4"-14 NPTF	steel	3.03	77.0	2.35	59.7	1-3/4	1.98	-	10
3/4"	6STF6-SS	3/4"-14 NPTF	316 stainless	3.03	77.0	2.35	59.7	1-3/4	2.05	-	10
1"	8STF8	1"-11 1/2 NPTF	steel	3.33	84.6	2.73	69.3	2	2.78	-	10
1"	8STF8-SS	1"-11 1/2 NPTF	316 stainless	3.33	84.6	1.55	39.3	2	2.83	-	10
1"	8STF10	1-1/4"-11 1/2 NPTF	steel	3.67	93.2	2.73	69.3	2	2.84	-	10
1"	8STF10-SS	1-1/4"-11 1/2 NPTF	316 stainless	3.67	93.2	2.73	69.3	2	2.90	-	10

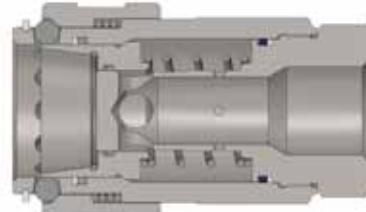

Body Size	ST-Series Snap-Tite 71-Series 'Old Style' Interchange Coupler (Female Threads)										
	Part Detail			Length		Maximum OD		Hex Inch	Weight Lb	Package Qty	
	Part #	Threads	Material	Inch	mm	Inch	mm			Bag	Box
1"	8STF8-V2	1"-11 1/2 NPTF	steel	4.55	115.6	2.74	69.6	2	2.83	-	10
1"	8STF10-V2	1-1/4"-11 1/2 NPTF	steel	4.90	124.5	2.74	69.6	2	2.87	-	10
2"	16STF12	1-1/2"-11 1/2 NPTF	steel	6.20	157.5	4.47	113.5	3.78	9.07	-	1
2"	16STF16	2"-11 1/2 NPTF	steel	6.20	157.5	4.47	113.5	3.78	8.74	-	1
2"	16STF16-SS	2"-11 1/2 NPTF	316 stainless	6.20	157.5	4.47	113.5	3.78	8.74	-	1

Note: BSP & ORB threads are available on request.



ST-Series Hydraulic Couplings

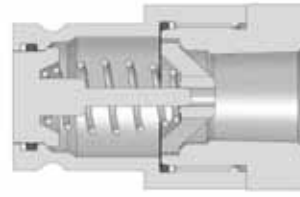

Body Size	ST-Series Snap-Tite 71-Series Interchange Nipple (Female Threads)										
	Part Detail			Length		Maximum OD		Hex Inch	Weight Lb	Package Qty	
	Part #	Threads	Material	Inch	mm	Inch	mm			Bag	Box
1/4"	ST2F2	1/4"-18 NPTF	steel	1.84	46.7	0.90	22.9	13/16	0.16	5	25
1/4"	ST2F2-SS	1/4"-18 NPTF	316 stainless	1.84	46.7	0.90	22.9	13/16	0.16	5	25
3/8"	ST3F2	1/4"-18 NPTF	steel	2.32	58.9	1.48	37.6	1	0.29	5	25
3/8"	ST3F3	3/8"-18 NPTF	steel	2.32	58.9	1.48	37.6	1	0.26	5	25
3/8"	ST3F3-SS	3/8"-18 NPTF	316 stainless	2.32	58.9	1.48	37.6	1	0.26	5	25
3/8"	ST3F4	1/2"-14 NPTF	steel	2.32	58.9	1.48	37.6	1	0.26	5	25
3/8"	ST3F4-SS	1/2"-14 NPTF	316 stainless	2.32	58.9	1.48	37.6	1	0.26	5	25
1/2"	ST4F4	1/2"-14 NPTF	steel	2.37	60.2	1.65	41.9	1-1/2	0.42	-	20
1/2"	ST4F4-SS	1/2"-14 NPTF	316 stainless	2.37	60.2	1.65	41.9	1-1/2	0.42	-	20
3/4"	ST6F6	3/4"-14 NPTF	steel	2.96	75.2	1.92	48.8	1-3/4	1.09	-	10
3/4"	ST6F6-SS	3/4"-14 NPTF	316 stainless	2.96	75.2	1.92	48.8	1-3/4	1.14	-	10
1"	ST8F8	1"-11 1/2 NPTF	steel	3.22	81.8	2.10	53.3	1-7/8	1.48	-	10
1"	ST8F8-SS	1"-11 1/2 NPTF	316 stainless	3.22	81.8	2.10	53.3	1-7/8	1.56	-	10
1"	ST8F10	1-1/4"-11 1/2 NPTF	steel	3.48	88.4	2.20	55.9	2	1.63	-	10
1"	ST8F10-SS	1-1/4"-11 1/2 NPTF	316 stainless	3.48	88.4	2.20	55.9	2	1.69	-	10

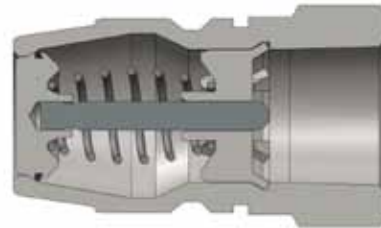

Body Size	ST-Series Snap-Tite 71-Series 'Old Style' Interchange Nipple (Female Threads)										
	Part Detail			Length		Maximum OD		Hex Inch	Weight Lb	Package Qty	
	Part #	Threads	Material	Inch	mm	Inch	mm			Bag	Box
1"	ST8F8-V2	1"-11 1/2 NPTF	steel	3.26	82.8	1.92	48.8	1-3/4	1.53	-	10
1"	ST8F10-V2	1-1/4"-11 1/2 NPTF	steel	3.5	88.9	1.98	50.3	2	1.48	-	10
2"	ST16F12	1-1/2"-11 1/2 NPTF	steel	4.50	114.3	3.48	88.4	3-1/4	4.32	-	1
2"	ST16F16	2"-11 1/2 NPTF	steel	4.50	114.3	3.48	88.4	3-1/4	4.16	-	1
2"	ST16F16-SS	2"-11 1/2 NPTF	316 stainless	4.50	114.3	3.48	88.4	3-1/4	4.16	-	1

Note: BSP & ORB threads are available on request.



ST-Series Hydraulic Couplings



Body Size	ST-Series Coupler Dust Plug					
	Part Detail			Weight Lb	Package Qty	
	Part #	Lanyard	Body		Bag	Box
1/4"	2STDP-A	SS Bead Chain	aluminum	0.15	5	25
3/8"	3STDP-A	SS Bead Chain	aluminum	0.18	5	25
1/2"	4STDP-A	SS Bead Chain	aluminum	0.23	5	25
3/4"	6STDP-A	SS Bead Chain	aluminum	0.36	-	10
1"	8STDP-A	SS Bead Chain	aluminum	0.39	-	10
1"-V2	8STDP-A-V2	SS Bead Chain	aluminum	0.48	-	10
2"	16STDP-A	SS Bead Chain	aluminum	0.94	-	1



Body Size	ST-Series Nipple Dust Cap					
	Part Detail			Weight Lb	Package Qty	
	Part #	Lanyard	Body		Bag	Box
1/4"	ST2DC-A	SS Bead Chain	aluminum	0.16	5	25
3/8"	ST3DC-A	SS Bead Chain	aluminum	0.19	5	25
1/2"	ST4DC-A	SS Bead Chain	aluminum	0.22	5	25
3/4"	ST6DC-A	SS Bead Chain	aluminum	0.26	-	10
1"	ST8DC-A	SS Bead Chain	aluminum	0.28	-	10
1"-V2	ST8DC-A-V2	SS Bead Chain	aluminum	0.46	-	10
2"	ST16DC-A	SS Bead Chain	aluminum	0.76	-	1

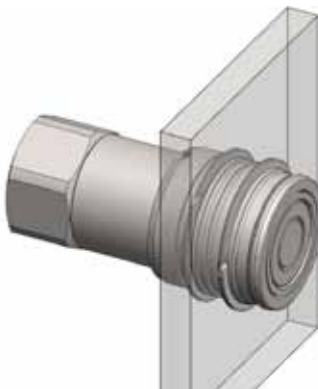

Body Size	ST-Series Snap-Tite 71-Series Interchange Coupler Bulkhead Kit				
	Part Detail		Bulkhead Kit Contents	Package Qty	
	Part #	Ring Material		Bag	Box
1/4"	2ST-BMK	steel	Two 360° Retaining Rings	1	25
3/8"	3ST-BMK	steel	Two 360° Retaining Rings	1	25
1/2"	4ST-BMK	steel	Two 360° Retaining Rings	1	25
3/4"	6ST-BMK	steel	Two 360° Retaining Rings	1	25

Note: BSP & ORB threads are available on request.



V-Series Hydraulic Couplings

Interchange Data:

- Interchangeable to MIL-C-51234
- Snap-Tite H/IH and Faster TNV/TNL

Materials:

- Machined components are manufactured using solid steel, brass, or 316 stainless steel bar stock.
- Stainless steel balls, retaining rings, and springs maximize corrosion resistance and extend service life.
- Steel componentry is plated using ROHS Compliant Trivalent Chrome.
- Steel coupler sleeves are hardened to resist deformation and maximize service life.
- Steel nipples are machined from high-strength steel and induction hardened.
- Tubular 'TV' valves are constructed from steel bar stock and are designed for optimum performance in pneumatic applications.

Seal Components:

- Nitrile (Buna-N) seals are standard, providing a temperature range of -40°F to +250°F (-40°C to +121°C).
- All couplers incorporate a Teflon® anti-extrusion ring to protect the seal components from dynamic impulse damage.
- 1/4" to 1" valve seals are crimped in place to maintain integrity during excessive flow conditions and pressurized connection.
- 1 1/4" to 2" valve O-rings are retained by a unique seal-groove profile and are field replaceable.

Note: Air flow data is presented using a coupler with a 'TV' valve and unvalved nipple. This configuration provides the optimal performance for pneumatic applications.

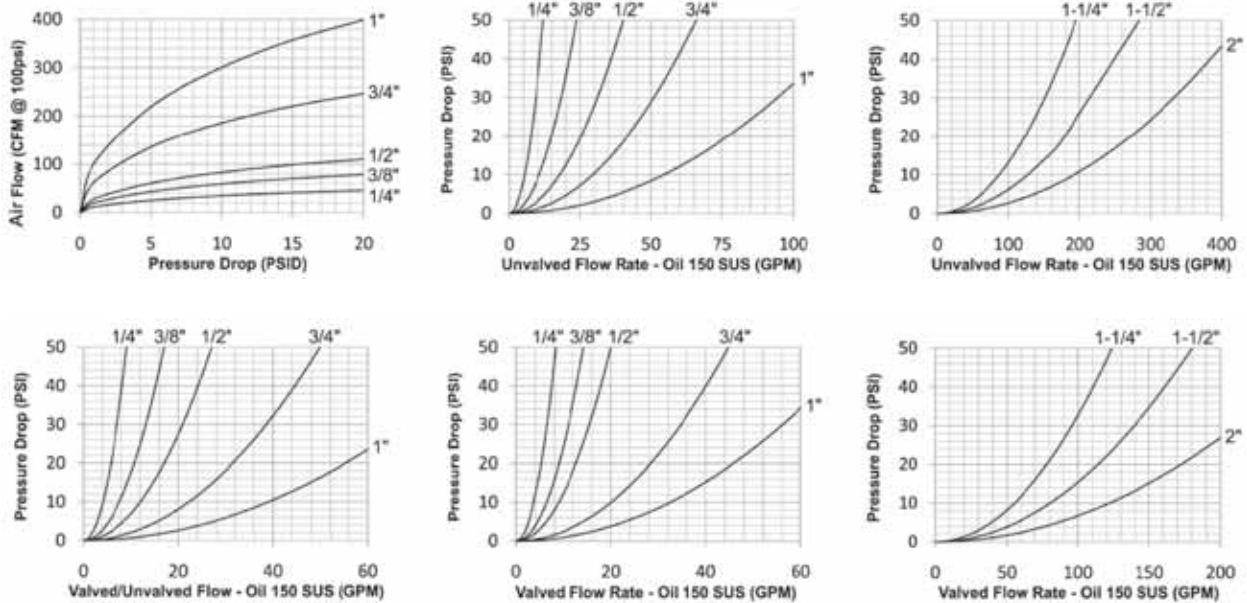

Rated Pressure Chart:

Body Size	V-Series Snap-Tite H/IH Interchange (Valved Connected)											
	Steel Coupler/Plug				Brass Coupler/Plug				316 SS Coupler/Plug			
	Maximum Working		Burst		Maximum Working		Burst		Maximum Working		Burst	
	PSI	Bar	PSI	Bar	PSI	Bar	PSI	Bar	PSI	Bar	PSI	Bar
1/4"	6,500	450	12,700	876	2,250	150	5,000	345	5,000	345	10,000	700
3/8"	4,500	310	10,500	700	2,250	150	5,300	350	4,000	275	8,000	550
1/2"	4,000	275	9,600	650	2,000	130	5,700	390	3,750	260	7,500	500
3/4"	3,500	240	9,100	600	2,000	130	5,300	350	2,000	130	7,500	500
1"	2,000	130	9,500	650	1,750	120	5,000	345	2,000	130	5,000	345
1 1/4"	1,750	120	5,000	345	350	24	1,000	70	1,500	100	3,000	200
1 1/2"	1,500	100	5,000	345	350	24	1,200	80	1,500	100	3,000	200
2"	1,500	100	4,000	275	400	28	1,000	70	500	34	1,000	70

Note: BSP & ORB threads are available on request.



V-Series Hydraulic Couplings

Body Size	V-Series Snap-Tite H/IH Interchange (Unvalved Connected)											
	Steel Coupler/Plug				Brass Coupler/Plug				316 SS Coupler/Plug			
	Maximum Working		Burst		Maximum Working		Burst		Maximum Working		Burst	
	PSI	Bar	PSI	Bar	PSI	Bar	PSI	Bar	PSI	Bar	PSI	Bar
¼"	11,000	760	29,500	2,000	4,000	275	14,200	980	10,000	670	29,200	2,000
⅜"	11,000	760	29,900	2,000	4,000	275	14,500	1,000	8,000	550	27,900	1,900
½"	11,000	760	29,300	2,000	4,000	275	14,500	1,000	8,000	550	24,600	1,700
¾"	9,000	620	19,300	1,300	3,500	250	11,100	750	7,000	480	22,600	1,500
1"	6,000	400	15,900	1,100	3,000	200	8,200	560	4,000	275	15,500	1,000
1¼"	5,000	345	10,000	700	1,000	70	4,000	275	3,000	200	10,000	700
1½"	5,000	345	10,000	700	1,000	70	4,000	275	3,000	200	10,000	700
2"	4,000	275	8,000	550	750	50	2,800	190	1,000	70	6,000	400

Note: Minimum burst pressure ratings were established under laboratory conditions using a Static Burst Unit (SBU). For high impulse applications and to meet Det Norske Veritas (DNV) compliance, the operating pressure must be divided by two (2) to ensure a 4:1 safety factor during system operation.

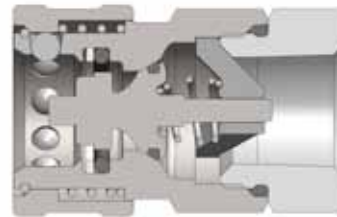

Body Size	V-Series Snap-Tite H/IH Interchange Valved Coupler (Female Threads)										
	Part Detail			Length		Maximum OD		Hex Inch	Weight Lb	Package Qty	
	Part #	Threads	Material	Inch	mm	Inch	mm			Bag	Box
¼"	2VF1	⅜"-27 NPTF	steel	1.68	42.7	0.99	25.1	⅞	0.22	5	50
¼"	2VF2	¼"-18 NPTF	steel	1.68	42.7	0.99	25.1	⅞	0.20	5	50
¼"	2VF2-B	¼"-18 NPTF	brass	1.68	42.7	0.99	25.1	⅞	0.20	5	50
¼"	2VF2-SS	¼"-18 NPTF	316 stainless	1.68	42.7	0.99	25.1	⅞	0.20	5	50
⅜"	3VF3	⅝"-18 NPTF	steel	1.94	49.3	1.18	30.0	1	0.37	5	50
⅜"	3VF3-B	⅝"-18 NPTF	brass	1.94	49.3	1.18	30.0	1	0.37	5	50
⅜"	3VF3-SS	⅝"-18 NPTF	316 stainless	1.94	49.3	1.18	30.0	1	0.38	5	50
⅜"	3VF4	½"-14 NPTF	steel	2.01	51.1	1.18	30.0	1	0.49	5	50
½"	4VF4	½"-14 NPTF	steel	2.13	54.1	1.36	34.5	1-⅜	0.49	5	25
½"	4VF4-B	½"-14 NPTF	brass	2.13	54.1	1.36	34.5	1-⅜	0.49	5	25
½"	4VF4-SS	½"-14 NPTF	316 stainless	2.13	54.1	1.36	34.5	1-⅜	0.52	5	25
½"	4VF6	¾"-14 NPTF	steel	2.13	54.1	1.36	34.5	1-⅜	0.58	5	25
¾"	6VF6	¾"-14 NPTF	steel	2.47	62.7	1.67	42.4	1-½	0.88	5	20
¾"	6VF6-B	¾"-14 NPTF	brass	2.47	62.7	1.67	42.4	1-½	0.88	5	20
¾"	6VF6-SS	¾"-14 NPTF	316 stainless	2.47	62.7	1.67	42.4	1-½	0.94	5	20
1"	8VF8	1"-11 ½ NPTF	steel	2.70	68.6	2.06	52.3	1-⅞	1.33	-	10
1"	8VF8-B	1"-11 ½ NPTF	brass	2.70	68.6	2.06	52.3	1-⅞	1.33	-	10
1"	8VF8-SS	1"-11 ½ NPTF	316 stainless	2.70	68.6	2.06	52.3	1-⅞	1.33	-	10

Note: BSP & ORB threads are available on request.



V-Series Hydraulic Couplings

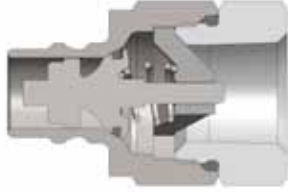

Body Size	V-Series Snap-Tite H/IH Interchange Valved Nipple (Female Threads)										
	Part Detail			Length		Maximum OD		Hex Inch	Weight Lb	Package Qty	
	Part #	Threads	Material	Inch	mm	Inch	mm			Bag	Box
1/4"	V2F1	1/8"-27 NPTF	steel	1.62	41.1	0.97	24.6	7/8	0.17	5	50
1/4"	V2F2	1/4"-18 NPTF	steel	1.62	41.1	0.97	24.6	7/8	0.14	5	50
1/4"	V2F2-B	1/4"-18 NPTF	brass	1.62	41.1	0.97	24.6	7/8	0.14	5	50
1/4"	V2F2-SS	1/4"-18 NPTF	316 stainless	1.62	41.1	0.97	24.6	7/8	0.15	5	50
3/8"	V3F3	3/8"-18 NPTF	steel	1.87	47.5	1.10	27.9	1	0.23	5	50
3/8"	V3F3-B	3/8"-18 NPTF	brass	1.87	47.5	1.10	27.9	1	0.23	5	50
3/8"	V3F3-SS	3/8"-18 NPTF	316 stainless	1.87	47.5	1.10	27.9	1	0.23	5	50
3/8"	V3F4	1/2"-14 NPTF	steel	1.94	49.3	1.10	27.9	1	0.27	5	50
1/2"	V4F4	1/2"-14 NPTF	steel	1.99	50.5	1.31	33.3	1-3/16	0.30	5	25
1/2"	V4F4-B	1/2"-14 NPTF	brass	1.99	50.5	1.31	33.3	1-3/16	0.30	5	25
1/2"	V4F4-SS	1/2"-14 NPTF	316 stainless	1.99	50.5	1.31	33.3	1-3/16	0.30	5	25
1/2"	V4F6	3/4"-14 NPTF	steel	1.99	50.5	1.31	33.3	1-3/16	0.38	5	25
3/4"	V6F6	3/4"-14 NPTF	steel	2.31	58.7	1.65	41.9	1-1/2	0.60	5	20
3/4"	V6F6-B	3/4"-14 NPTF	brass	2.31	58.7	1.65	41.9	1-1/2	0.60	5	20
3/4"	V6F6-SS	3/4"-14 NPTF	316 stainless	2.31	58.7	1.65	41.9	1-1/2	0.59	5	20
1"	V8F8	1"-11 1/2 NPTF	steel	2.60	66.0	2.06	52.3	1-7/8	0.93	-	10
1"	V8F8-B	1"-11 1/2 NPTF	brass	2.60	66.0	2.06	52.3	1-7/8	0.93	-	10
1"	V8F8-SS	1"-11 1/2 NPTF	316 stainless	2.60	66.0	2.06	52.3	1-7/8	0.94	-	10

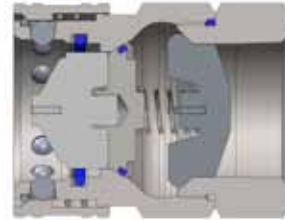

Body Size	V-Series Snap-Tite H/IH Interchange Valved Coupler (Female Threads)										
	Part Detail			Length		Maximum OD		Hex Inch	Weight Lb	Package Qty	
	Part #	Threads	Material	Inch	mm	Inch	mm			Bag	Box
1-1/4"	10VF10	1-1/4"-11 1/2 NPTF	steel	3.54	89.9	2.19	55.6	2	1.94	-	10
1-1/4"	10VF10-B	1-1/4"-11 1/2 NPTF	brass	3.54	89.9	2.19	55.6	2	1.94	-	10
1-1/4"	10VF10-SS	1-1/4"-11 1/2 NPTF	316 stainless	3.54	89.9	2.19	55.6	2	1.95	-	10
1-1/2"	12VF12	1-1/2"-11 1/2 NPTF	steel	3.27	83.1	2.74	69.6	2-1/2	2.95	-	5
1-1/2"	12VF12-B	1-1/2"-11 1/2 NPTF	brass	3.27	83.1	2.74	69.6	2-1/2	2.95	-	5
1-1/2"	12VF12-SS	1-1/2"-11 1/2 NPTF	316 stainless	3.27	83.1	2.74	69.6	2-1/2	2.94	-	5
2"	16VF16	2"-11 1/2 NPTF	steel	3.92	99.6	3.83	97.3	3-1/2	6.19	-	5
2"	16VF16-B	2"-11 1/2 NPTF	brass	3.92	99.6	3.83	97.3	3-1/2	6.19	-	5
2"	16VF16-SS	2"-11 1/2 NPTF	316 stainless	3.92	99.6	3.83	97.3	3-1/2	6.20	-	5

Note: BSP & ORB threads are available on request.



V-Series Hydraulic Couplings

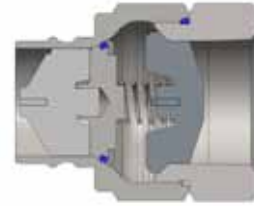

Body Size	V-Series Snap-Tite H/IH Interchange Valved Nipple (Female Threads)										
	Part Detail			Length		Maximum OD		Hex Inch	Weight Lb	Package Qty	
	Part #	Threads	Material	Inch	mm	Inch	mm			Bag	Box
1-1/4"	V10F10	1-1/4"-11 1/2 NPTF	steel	3.41	86.6	2.19	55.6	2	0.52	-	10
1-1/4"	V10F10-B	1-1/4"-11 1/2 NPTF	brass	3.41	86.6	2.19	55.6	2	0.52	-	10
1-1/4"	V10F10-SS	1-1/4"-11 1/2 NPTF	316 stainless	3.41	86.6	2.19	55.6	2	0.50	-	10
1-1/2"	V12F12	1-1/2"-11 1/2 NPTF	steel	3.11	79.0	2.74	69.6	2-1/2	2.13	-	5
1-1/2"	V12F12-B	1-1/2"-11 1/2 NPTF	brass	3.11	79.0	2.74	69.6	2-1/2	2.13	-	5
1-1/2"	V12F12-SS	1-1/2"-11 1/2 NPTF	316 stainless	3.11	79.0	2.74	69.6	2-1/2	2.12	-	5
2"	V16F16	2"-11 1/2 NPTF	steel	3.72	94.5	3.83	97.3	3-1/2	4.75	-	5
2"	V16F16-B	2"-11 1/2 NPTF	brass	3.72	94.5	3.83	97.3	3-1/2	4.75	-	5
2"	V16F16-SS	2"-11 1/2 NPTF	316 stainless	3.72	94.5	3.83	97.3	3-1/2	4.76	-	5



Body Size	V-Series Snap-Tite H/IH Interchange Unvalved Coupler (Female Threads)										
	Part Detail			Length		Maximum OD		Hex Inch	Weight Lb	Package Qty	
	Part #	Threads	Material	Inch	mm	Inch	mm			Bag	Box
1/4"	2VF2-E	1/4"-18 NPTF	steel	1.36	34.5	0.99	25.1	7/8	0.18	5	50
1/4"	2VF2-B-E	1/4"-18 NPTF	brass	1.36	34.5	0.99	25.1	7/8	0.18	5	50
1/4"	2VF2-SS-E	1/4"-18 NPTF	316 stainless	1.36	34.5	0.99	25.1	7/8	0.18	5	50
3/8"	3VF3-E	3/8"-18 NPTF	steel	1.50	38.1	1.18	30.0	7/8	0.28	5	50
3/8"	3VF3-B-E	3/8"-18 NPTF	brass	1.50	38.1	1.18	30.0	7/8	0.27	5	50
3/8"	3VF3-SS-E	3/8"-18 NPTF	316 stainless	1.50	38.1	1.18	30.0	7/8	0.29	5	50
1/2"	4VF4-E	1/2"-14 NPTF	steel	1.64	41.7	1.37	34.8	1-3/16	0.39	5	25
1/2"	4VF4-B-E	1/2"-14 NPTF	brass	1.64	41.7	1.37	34.8	1-3/16	0.39	5	25
1/2"	4VF4-SS-E	1/2"-14 NPTF	316 stainless	1.64	41.7	1.37	34.8	1-3/16	0.38	5	25
3/4"	6VF6-E	3/4"-14 NPTF	steel	1.96	49.8	1.67	42.4	1-1/2	0.64	5	20
3/4"	6VF6-B-E	3/4"-14 NPTF	brass	1.96	49.8	1.67	42.4	1-1/2	0.62	5	20
3/4"	6VF6-SS-E	3/4"-14 NPTF	316 stainless	1.96	49.8	1.67	42.4	1-1/2	0.61	5	20
1"	8VF8-E	1"-11 1/2 NPTF	steel	2.10	53.3	1.99	50.5	1-13/16	1.05	-	10
1"	8VF8-B-E	1"-11 1/2 NPTF	brass	2.10	53.3	1.99	50.5	1-13/16	1.02	-	10
1"	8VF8-SS-E	1"-11 1/2 NPTF	316 stainless	2.10	53.3	1.99	50.5	1-13/16	1.02	-	10
1-1/4"	10VF10-E	1-1/4"-11 1/2 NPTF	steel	2.28	57.9	2.19	55.6	2	1.08	-	10
1-1/4"	10VF10-B-E	1-1/4"-11 1/2 NPTF	brass	2.28	57.9	2.19	55.6	2	1.10	-	10
1-1/4"	10VF10-SS-E	1-1/4"-11 1/2 NPTF	316 stainless	2.28	57.9	2.19	55.6	2	1.10	-	10
1-1/2"	12VF12-E	1-1/2"-11 1/2 NPTF	steel	2.57	65.3	2.74	69.6	2-1/2	1.78	-	5
1-1/2"	12VF12-B-E	1-1/2"-11 1/2 NPTF	brass	2.57	65.3	2.74	69.6	2-1/2	1.78	-	5
1-1/2"	12VF12-SS-E	1-1/2"-11 1/2 NPTF	316 stainless	2.57	65.3	2.74	69.6	2-1/2	1.78	-	5
2"	16VF16-E	2"-11 1/2 NPTF	steel	2.48	63.0	3.56	90.4	3-3/4	3.12	-	5
2"	16VF16-B-E	2"-11 1/2 NPTF	brass	2.48	63.0	3.56	90.4	3-3/4	3.13	-	5
2"	16VF16-SS-E	2"-11 1/2 NPTF	316 stainless	2.48	63.0	3.56	90.4	3-3/4	3.13	-	5

Note: BSP & ORB threads are available on request.



V-Series Hydraulic Couplings

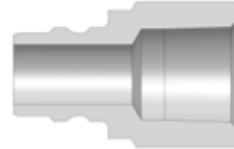

Body Size	V-Series Snap-Tite H/IH Interchange Unvalved Nipple (Female Threads)										
	Part Detail			Length		Maximum OD		Hex Inch	Weight Lb	Package Qty	
	Part #	Threads	Material	Inch	mm	Inch	mm			Bag	Box
¼"	V2F2-E	¼"-18 NPTF	steel	1.27	32.3	0.69	17.5	⅝	0.05	5	50
¼"	V2F2-B-E	¼"-18 NPTF	brass	1.27	32.3	0.69	17.5	⅝	0.06	5	50
¼"	V2F2-SS-E	¼"-18 NPTF	316 stainless	1.27	32.3	0.69	17.5	⅝	0.06	5	50
⅜"	V3F3-E	⅜"-18 NPTF	steel	1.41	35.8	0.90	22.9	1⅜	0.08	5	50
⅜"	V3F3-B-E	⅜"-18 NPTF	brass	1.41	35.8	0.90	22.9	1⅜	0.08	5	50
⅜"	V3F3-SS-E	⅜"-18 NPTF	316 stainless	1.41	35.8	0.90	22.9	1⅜	0.08	5	50
½"	V4F4-E	½"-14 NPTF	steel	1.72	43.7	1.10	27.9	1	0.18	5	25
½"	V4F4-B-E	½"-14 NPTF	brass	1.72	43.7	1.10	27.9	1	0.18	5	25
½"	V4F4-SS-E	½"-14 NPTF	316 stainless	1.72	43.7	1.10	27.9	1	0.18	5	25
¾"	V6F6-E	¾"-14 NPTF	steel	1.86	47.2	1.31	33.3	1-⅜	0.22	5	20
¾"	V6F6-B-E	¾"-14 NPTF	brass	1.86	47.2	1.31	33.3	1-⅜	0.22	5	20
¾"	V6F6-SS-E	¾"-14 NPTF	316 stainless	1.86	47.2	1.31	33.3	1-⅜	0.22	5	20
1"	V8F8-E	1"-11 ½ NPTF	steel	2.08	52.8	1.65	41.9	1-½	0.38	-	10
1"	V8F8-B-E	1"-11 ½ NPTF	brass	2.08	52.8	1.65	41.9	1-½	0.38	-	10
1"	V8F8-SS-E	1"-11 ½ NPTF	316 stainless	2.08	52.8	1.65	41.9	1-½	0.38	-	10
1-¼"	V10F10-E	1-¼"-11 ½ NPTF	steel	2.22	56.4	2.06	52.3	1-⅞	0.57	-	10
1-¼"	V10F10-B-E	1-¼"-11 ½ NPTF	brass	2.22	56.4	2.06	52.3	1-⅞	0.56	-	10
1-¼"	V10F10-SS-E	1-¼"-11 ½ NPTF	316 stainless	2.22	56.4	2.06	52.3	1-⅞	0.56	-	10
1-½"	V12F12-E	1-½"-11 ½ NPTF	steel	2.44	62.0	2.33	59.2	2-⅞	0.84	-	5
1-½"	V12F12-B-E	1-½"-11 ½ NPTF	brass	2.44	62.0	2.33	59.2	2-⅞	0.84	-	5
1-½"	V12F12-SS-E	1-½"-11 ½ NPTF	316 stainless	2.44	62.0	2.33	59.2	2-⅞	0.83	-	5
2"	V16F16-E	2"-11 ½ NPTF	steel	2.60	66.0	3.01	76.5	2-¾	1.34	-	5
2"	V16F16-B-E	2"-11 ½ NPTF	brass	2.60	66.0	3.01	76.5	2-¾	1.34	-	5
2"	V16F16-SS-E	2"-11 ½ NPTF	316 stainless	2.60	66.0	3.01	76.5	2-¾	1.35	-	5



Body Size	V-Series Coupler Rigid Dust Plug					
	Part Detail			Weight Lb	Package Qty	
	Part #	Lanyard	Body		Bag	Box
¼"	2VDP-A	SS Bead Chain	aluminum	0.02	5	50
⅜"	3VDP-A	SS Bead Chain	aluminum	0.02	5	50
½"	4VDP-A	SS Bead Chain	aluminum	0.03	5	25
¾"	6VDP-A	SS Bead Chain	aluminum	0.09	5	20
1"	8VDP-A	SS Bead Chain	aluminum	0.14	-	10
1-¼"	10VDP-A	SS Bead Chain	aluminum	0.29	-	10
1-½"	12VDP-A	SS Bead Chain	aluminum	0.31	-	10
2"	16VDP-A	SS Bead Chain	aluminum	0.49	-	10



Body Size	V-Series Nipple Rigid Dust Cap					
	Part Detail			Weight Lb	Package Qty	
	Part #	Lanyard	Body		Bag	Box
¼"	V2DC-A	SS Bead Chain	aluminum	0.03	5	50
⅜"	V3DC-A	SS Bead Chain	aluminum	0.07	5	50
½"	V4DC-A	SS Bead Chain	aluminum	0.13	5	25
¾"	V6DC-A	SS Bead Chain	aluminum	0.19	5	20
1"	V8DC-A	SS Bead Chain	aluminum	0.26	-	10
1-¼"	V10DC-A	SS Bead Chain	aluminum	0.25	-	10
1-½"	V12DC-A	SS Bead Chain	aluminum	0.37	-	10
2"	V16DC-A	SS Bead Chain	aluminum	0.52	-	10

Note: BSP & ORB threads are available on request.

Dixon Powhatan Fire Products

Angle Hose Valves 18-157 / 18-158

- U/L listed and FM Approved
- Material: cast brass with an aluminum hand wheel
- Working pressure: 300 PSI



female x male
18-157



female x female
18-158

Adjustable Pressure Restricting Device

- Material: cast brass
- Intended for installation on Class I or Class III standpipe hose outlets
- Use of this device restricts pressure in the piping system to such a degree that hose lines can be handled by persons untrained in the handling of heavy fire streams
- New York City Board of Standards & Appeals, approval# MEA 54-07-E
- 2½" U/L listed
- Working pressure: 175 PSI



female x male
18-255

Factory Set Pressure Reducing (regulating) Brass Valves 18-457 / 18-458

- Pressure Reducing (regulating) Valves are listed by:
 1. Underwriters Laboratories for Automatic Sprinkler Systems as floor or zone control valves
 2. Standpipe Systems, Class I, II and III
 3. Automatic Check Valve for Dual Riser Systems
 4. Approved by the New York City Board of Standards and Appeals, approval# MEA 54-07-E
 5. Approved by the City of Los Angeles and the City of San Francisco (ULC 2½")
- True combination shut-off and pressure reducing valves. 1½" size reduces inlet pressure of 300 PSI (2069 kPa) or less to working pressures of 10 through 175 PSI (69-1207 kPa). 2½" size reduces inlet pressures of 400 PSI (2758 kPa) or less to desired working pressures from 20 through 175 PSI (138-1207 kPa) under discharge or static conditions.
- Female x female valves are furnished with OPEN / CLOSED Indicator Bonnet for rapid confirmation of the valves status in the system.
- Factory valves are tamper resistant
- Material: cast brass



female x male
18-457



female x female
18-458

Dimensions						
Size	A	B	C	D	E - closed	E - open
1½"	2-7/32"	4-5/32"	3-7/8"	3-3/4"	9-25/64"	8-53/64"
2½"	3-7/32"	6-3/32"	5-3/4"	5-3/4"	11-3/8"	10-13/16"

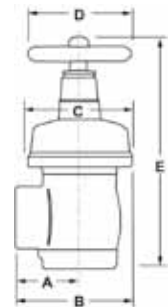

Valves are available with a tamper proof switch as an accessory device to hasten valve operation while monitoring its open condition. The complete switch, with bracket and housing, is available for field mounting. Consult the factory for price and availability.

Adapters

- Material: cast brass and aluminum
- Threads available: NST, NYFD, NYC, NPT, GHT
- Various configurations available on request



Caps & Plugs

- Material: cast brass, aluminum and plastic
- Threads available: NST, NPSH
- Various configurations available on request



Nozzles

- Material: brass
- UL / FM approved
- For use up to 100 PSI with water only (high pressure nozzles up to 300 PSI)
- Threads available: GHT, NPSH, NST, NYFD, ULT



Fire Hose

- Hose Material: synthetic / polyester
- Lug Material: brass or aluminum
- Pin rack is UL / FM approved and comes in red steel enamel
- Hoses come coupled or uncoupled
- Fitting threads available: NPSH, NST
- Other lengths and threads are available

